

Signs of Water Problems

If you have a public water supply, your water is regularly tested. However, pipes in your own home or apartment complex can affect the water after it enters your home.

If you are drinking water from your own well, spring or cistern, you should test the water every year. The best time to test is in the spring. Check with your local health department or county extension office to find out what labs test water in your area.



There are signs that mean you could be having water problems. You need to have your water supply tested right away if:

- Family members or friends who visit have trouble with stomach illnesses over and over again.
- Household plumbing has lead pipes, fittings, or solder joints. Or you suspect that the pipes might be lead.

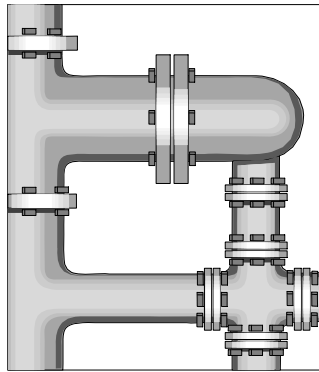

- Water leaves rust-colored stains on plumbing fixtures and laundry.
- Water has a bad taste or smell.
- Pipes or plumbing show signs of wearing away.

- Water appears cloudy, bubbly, or colored for more than a minute after it comes from the faucet.

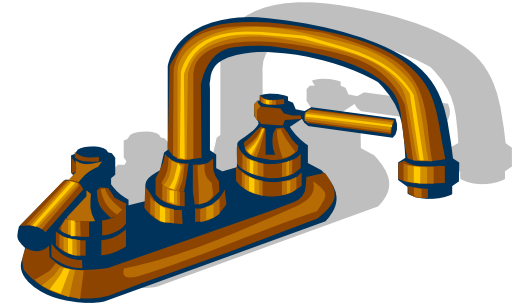

- Water leaves a scaly residue in kettles or on heads of water fixtures.
- Soap scum is left in sinks, around bathtubs, on showers or on bath tile.
- Detergents don't clean as well in the laundry.

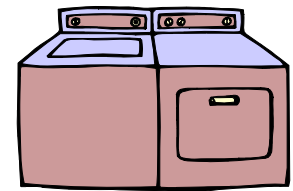

- Water supply equipment like pumps wear out quickly even if the pump is the right size.

Common Causes of Water Problems

If you have your own water system, where you live or what goes on around you can affect your water. Test your water if:

- Your well is located in an area where people have their own septic systems.

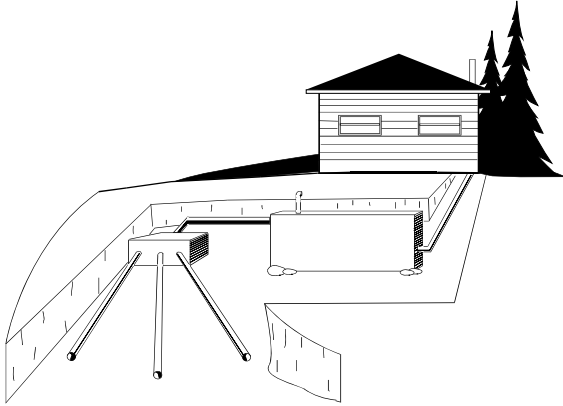

- Your well is in an area where a lot of farming is taking place.

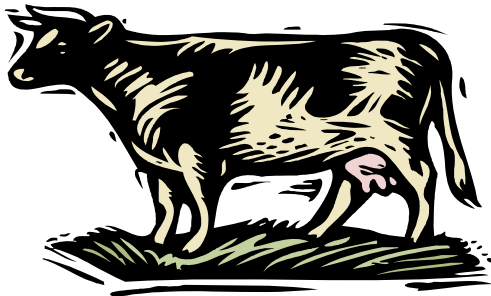

- You live near a coal or other mining operation.



- Your well is near a gas drilling operation or gas well.
- Your well is near a dump, junkyard, landfill, dry cleaning operation, or factory.



Written by: Denise Hoffman, Linda M. Heaton, Kim Henken and Jenny Cocanougher.

This material is based upon work supported by the Cooperative State Research, Education, and Extension Service, U.S. Department of Agriculture, under special project number EWQI-10395.

Educational programs of the Kentucky Cooperative Extension Service serve all people regardless of race, color, age, sex, religion, disability, or national origin.

April, 1999
Revised March 2007

Having Problems with Your Water?

Some Signs that Tell You to Have Your Water Tested

Possible Causes of Water Problems

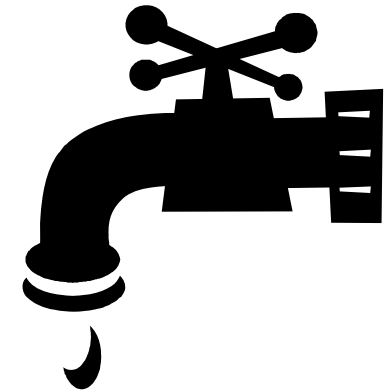

COOPERATIVE EXTENSION SERVICE



UNIVERSITY OF KENTUCKY
College of Agriculture